



Parasit's Discod for BGE Guide

Version March 2017
(c) by Parasit

Download and Installation

Find and dl the client (Mac OSX, Windows, Linux):
<https://discordapp.com/apps>
Once downloaded, launch and install Discord.

You have to register with Discord, but it doesn't has to be your BGE name an password.

Add the BGE Servers

After the installation, Discord should look like this:

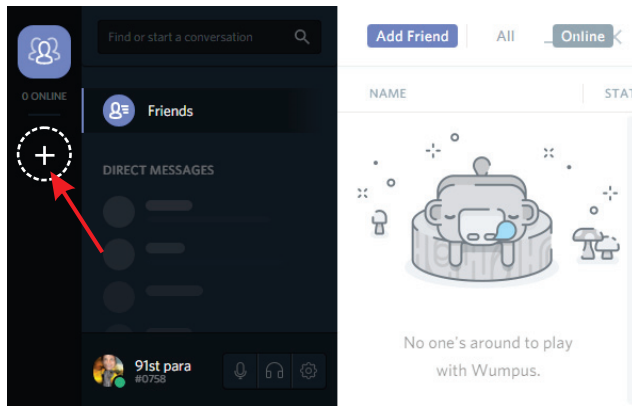

Click on the + sign and then "Join a Server"

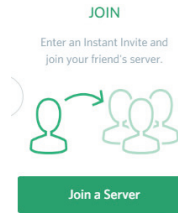

For Allied enter this Link:
<https://discord.gg/37mNNdm>

For Axis enter this Link:
<https://discord.gg/hZySQUR>

You can join both servers.

Now it looks like this:

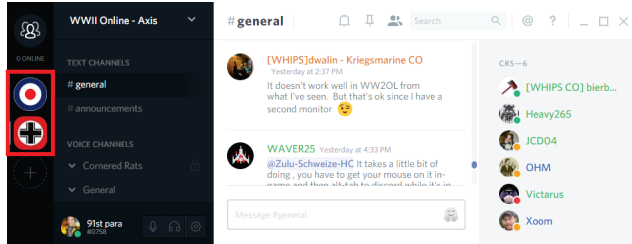

Settings

On the bottom left side you find the icon for the settings:

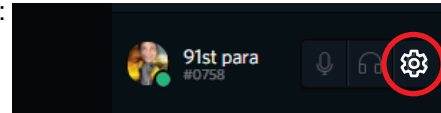

click on it and setup Discord.

Account: setup displayed name and picture

Nitro: unimportant

Connections: unimportant

Friends: leave it at Everyone

Text & Images: leave it the way it is

Voice: setup your Push to Talk

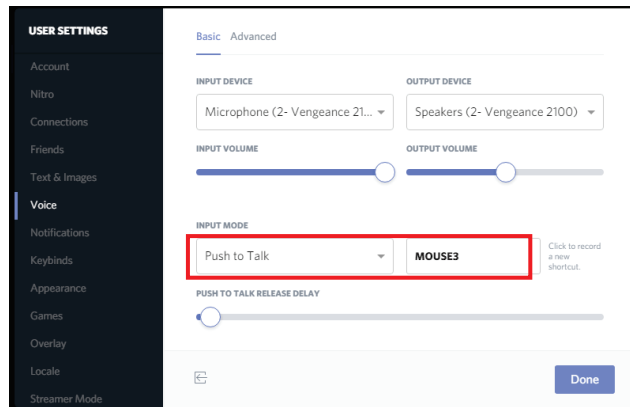

Notifications: personal preference, but I would turn TEXT-TO-SPEECH on Never or you will hear each text messages spoken by a computer

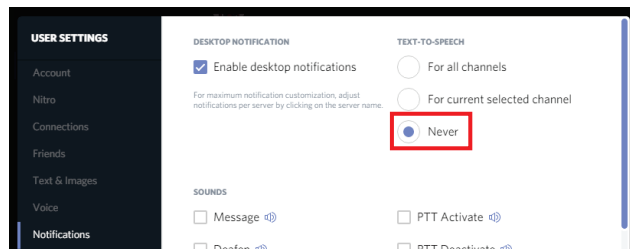

Settings II

Keybinds: you can add other buttons e.g. 2nd Push-To-Talk or Deafen I would add "Toggle Deafen" to have the possibility to mute the chat (e.g. capping).

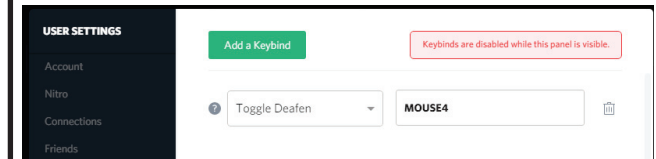

Appearance: just look and feel

Games: Here you can set Overlay for BGE
- start BGE
- click **Add it!** (green)
- chose WWIOL
- click on Overlay

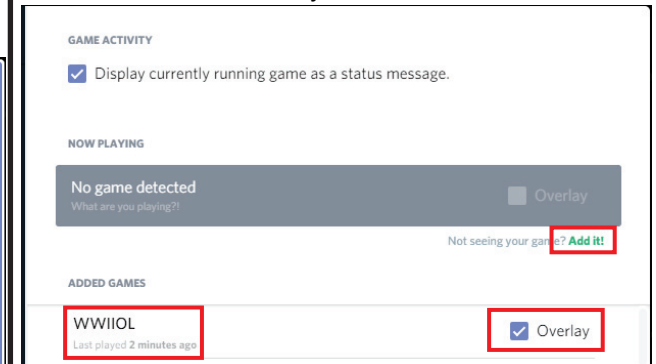

Overlay: Here you can set the button to see additional functions in-game (Important if you want to move the overlay)

Locale / Streamer / Security: unimportant

Moving the Overlay:

- Start Discord and BGE
- Press the chosen "Toggle Overlay Lock" (see Overlay)
- Alt Tab to get out of BGE lock
- move Overlay with mouse (you'll notice a delay), so move it and wait a bit. Be patient!
- Once you have the desired position, press "Toggle Overlay Lock" key's again.